

ILLUSTRATED PARTS - MODEL 585

SL585 ILLUSTRATED PARTS

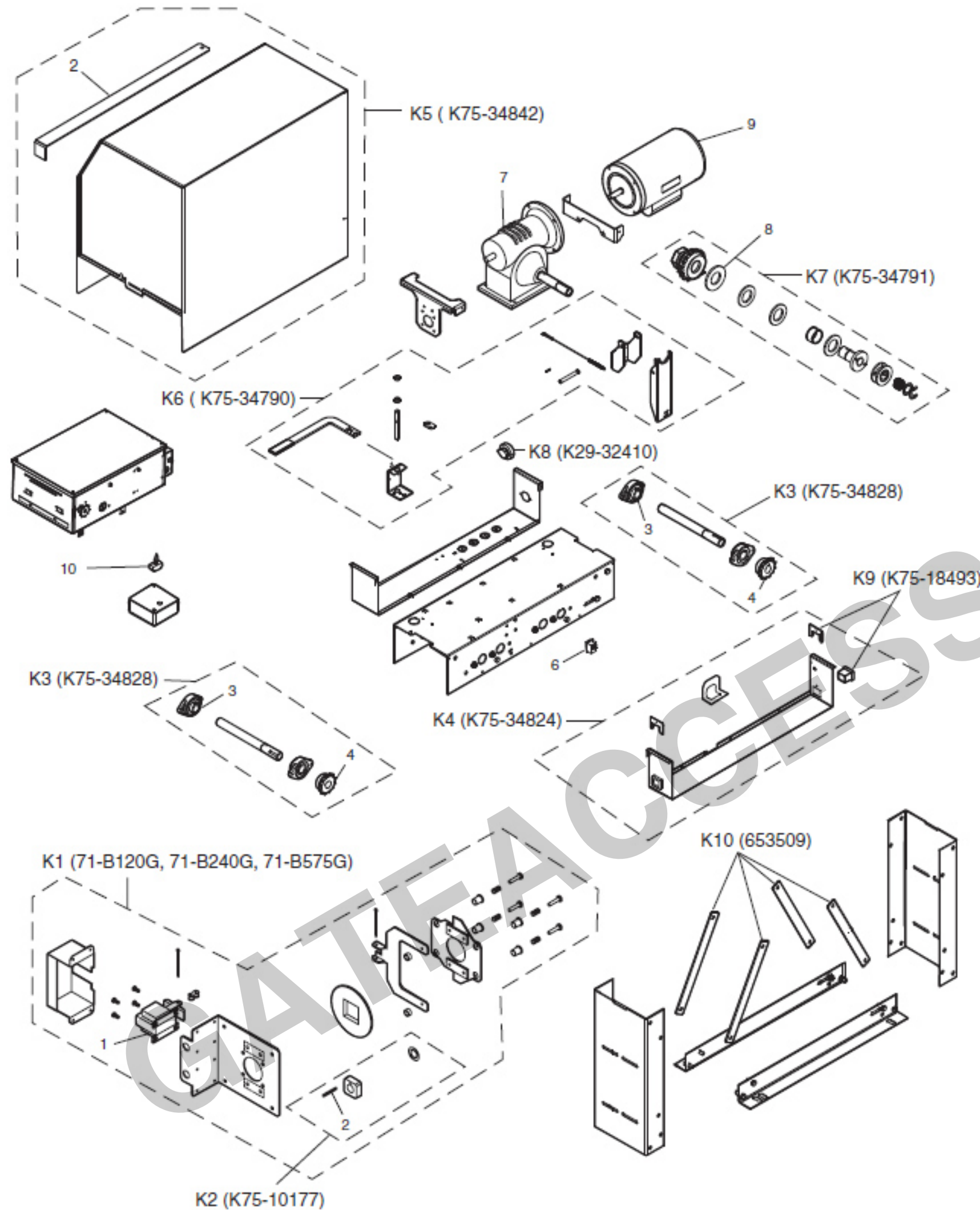

REPAIR PARTS - MODEL SL585

INDIVIDUAL PARTS

ITEM	PART #	DESCRIPTION
1	22-120	Brake solenoid, 115V
	22-240	Brake solenoid, 230/460V
	22-575-1	Brake solenoid, 575V
2	80-14414	Feather key
3	12-4164	Bearing
4	15-50B12LGH	Sprocket, 50B12 x 1"
5	10-30678	Lock bar
6	23-34815	Stop/Reset button
7	32-34792	Gear reducer (30:1)
8	39-34786	Clutch disk
9	K20-1050C-2P	Motor - models SL585-50-11, SL585-50-21, SL585-50-81
	K20-3050C-4P	Motor - models SL585-50-23, SL585-50-43, SL585-50-83
	K20-3050M-5	Motor - model SL585-50-53
	K20-1100C-2P	Motor - models SL585-100-11, SL585-100-21, SL585-100-81
	K20-3100C-4P	Motor - models SL585-100-23, SL585-100-43, SL585-100-83
	K20-3100M-5	Motor - model SL585-100-53
	K20-1150C-2P	Motor - models SL585-150-11, SL585-150-21

VARIABLE PARTS

10	23-3001	On/off switch - 1 phase 115 - 208/230V
	23-3005	On/off switch - 3 phase

NOT SHOWN

Gate bracket
Take up bolt
Chain
Bolt - 14"

01-34850	Owner's manual - English
01-34850SP	Owner's manual - Spanish
01-34850FR	Owner's manual - French

SERVICE KITS

ITEM	PART #	DESCRIPTION
K1	71-B120G	Brake kit - 115 Volt models
	71-B240G	Brake kit - 230/460 Volt models
	71-B575G	Brake kit - 575 Volt models
		Complete with: Brake hub kit, brake release lever, brake disk, spring cup, studs, compression springs, brake solenoid, solenoid cover, spacers, mounting plate, pressure plate, feather key and conduit.
K2	K75-10177	Brake hub kit
		Complete with: Brake hub, set screw, push on fastener and feather key.
K3	K75-34828	Idler shaft kit
		Complete with: Bearings, sprocket 50B12x1" and idler shaft
K4	K75-34824	Chain guard kit
		Complete with: Chain guard, chain guides and retainers.
K5	K75-34842	Cover kit
		Complete with: Cover, lock bar and label.
K6	K75-34790	Disconnect kit
		Complete with: Release lever, bracket, cable, compression spring, washer, screws, clevis pin, bushings, roll pins, bolts, nuts, and handle.
K7	K75-34791	Clutch kit
		Complete with: Clutch disk, clutch plate, hub, torque limiter, e-rings, washers, sprocket, bearing, nut and compression spring.
K8	K29-32410	Alarm kit
		Complete with: Alarm, spacer and faston.
K9	K75-18493	Chain guide kit
K10	653509	Optional diagonal brace kit

NOT SHOWN

71-6532449	Heater kits (Optional) - 115/575V Operators
71-6532448	Heater kits (Optional) - 208/230/460V Operators
K50-18423	Replacement heater with thermostat only